

ONE·TOUCH™

[www.ONETOUCHPRODUCTS.com](http://www.ONETOUCHPRODUCTS.com)

Automatic  
**Bottle  
Opener**



**USER MANUAL**

Model no.: KC45

## INTRODUCTION

*Congratulations on your purchase of an Automatic Bottle Opener (Model No.: KC45). This incredible product will help you open almost all bottle caps effortlessly. The Automatic Bottle Opener is simple to use. Place the unit with appropriate adapter on the bottle cap. Then, just press and hold the buttons, the seal is broken and the cap is open within seconds.*

### **IMPORTANT SAFETY INSTRUCTIONS**

Read all instructions carefully before using your Automatic Bottle opener

- Close supervision is necessary when your Automatic Bottle Opener is used near children.
- DO NOT operate the product with wet hands.
- Switch the unit off after use.
- Clean the Automatic Bottle Opener with a damp cloth. Never immerse the unit in water or any liquid.
- Store your Automatic Bottle Opener out of reach of children.
- Always remove the batteries when storing the unit for a long period of time.

## PARTS

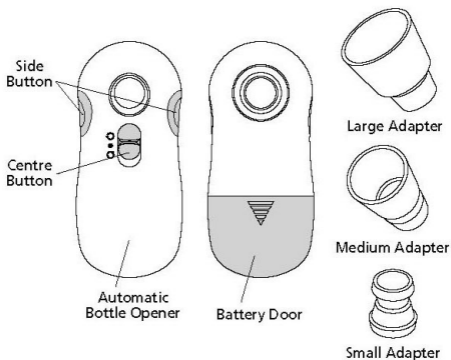

## GETTING STARTED

### Battery Installation

1. Switch off the Automatic Bottle Opener by flipping the Centre Button to the middle.
2. Push the battery door outwards on the arrow trail and take it out wholly.

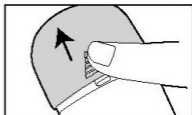
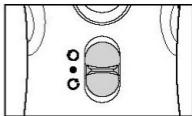

3. Install 2 AA alkaline or rechargeable batteries into the battery compartment according to the polarity (+/-) instruction.
4. Put the battery door in place after the batteries have been installed.
5. Always replace all batteries at one go and never mix old and new batteries or batteries of different types.
6. Take out the batteries if the Automatic Bottle Opener is stored for a long time.

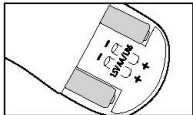

### Operating the Automatic Bottle Opener

For a better result, use a cloth to dry the bottle cap first if necessary.

1. Attach the appropriate adapter to the unit if necessary.
2. Place the unit over the bottle cap and press it down to grip the cap firmly.
3. Switch on the unit by flipping the Centre Button to the front position.

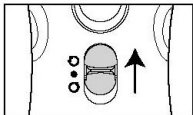
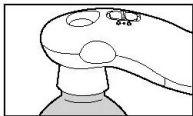
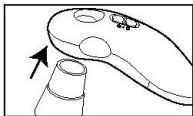

4. Press and hold the Side Buttons to start twisting. The bottle cap (and adapter if used) will turn automatically.
5. Lift up the unit after the seal is broken and the cap is opened.
6. When closing the cap, put back the cap on the bottle.
7. Place the unit (with adapter if used) over the cap and press it down slightly to grip the cap firmly.
8. Flip the Centre Button to the rear position.
9. Press and hold the Side Buttons. The bottle cap will close automatically.
10. After closing, lift the unit (with adapter if used) up.
11. Switch the unit off by flipping the Centre Button to the middle position



### Cleaning and Care

1. Switch the Automatic Bottle Opener off.
2. Wash the adapters with warm water.
3. Remove the batteries and clean the unit with a damp cloth.
4. Always remove the batteries when storing the unit for a long period of time.
5. Store the unit and the adapters out of reach of children.

## TROUBLE SHOOTING

The unit does not work.	Flip the Centre Button to the front or rear position. The batteries are installed in an incorrect polar direction or the batteries are used up.
Bottle cap is not opened.	Make ensure the cap is firmly gripped by the cup or the adapter. Push the unit down on the bottle cap while pressing the Side Buttons.
The Battery Door cannot be opened.	Press on the arrow trail on the door and push it out.

## SPECIFICATIONS

Dimension: 142 x 63 x 55 mm

Storage temperature: 10 to 40°C (50 to 104°F)

Battery: 2 x AA alkaline or rechargeable batteries